

# TOKYO PEDAL SUMMIT 2024

## Exhibitor Information



**TOKYO PEDAL SUMMIT**

**10.26 sat. 10.27 sun.**

**CITY HALL AND GALLERY GOTANDA**

Illustration: Matt Horak

The poster features a stylized illustration of a pedalboard with various pedals, knobs, and switches, set against a blue background. The text is in a bold, white, sans-serif font. The event dates and location are prominently displayed below the title.

**TOKYO PEDAL SUMMIT 2024**  
**Saturday - Sunday, Oct 26 - 27. 2024**  
**at CITY HALL & GALLERY GOTANDA**

Information has been released

## The biggest and hottest guitar pedal event in Japan!

The Tokyo Pedal Summit is Japan's premier effect pedal event for all things that make your instrument go whirrrrr, bleep, zzzzaaapp, grrrrr, or ping (ping ping ping ping ping ping ping )! Last held in November 2022 in Akihabara, it makes a triumphal return this year!

A celebration of the sonic potential contained in little boxes, the Tokyo Pedal Summit brings effect pedal makers from Japan and around the world together with thousands of musicians and enthusiasts for a weekend of musical exploration through exhibition, events, and discussions.

We hope for the Pedal Summit to be an event for pedal manufacturers and related companies and brands from not just Japan, but all over the world, to create two heavenly days for diving into the world of effects pedals. We also hope for the 2024 Tokyo Pedal Summit to be an opportunity for participants to reach out and communicate and engage in effective promotions with pedal fans not just from Japan, but all over Asia.

The 2024 Pedal Summit will be held October 26th~27th in Tokyo at the Gallery Gotanda located 5 minutes from Gotanda station in Tokyo. Entrance will be free to the general public. Just show up and enjoy!

# Overview

☐ Name: Tokyo Pedal Summit 2024

☐ Date: 2024

**【Set Up Day】**

Friday, 25 October 1:00 PM - 6:00PM (open to exhibitors and dealers only)

**【Event days】**

Saturday, 26 October 11:00 AM-6:00 PM

Sunday, 27 October 10:00 AM-5:00 PM (all take down and load out must be completed by 10:00PM)

☐ Venue : CITY HALL AND GALLERY GOTANDA

8-4-13, Nishi-Gotanda, Shinagawa, Tokyo, Japan

30 minutes by train from Shinjuku.

☐ Entrance Fee : Free to the General Public

(Entrance to the exhibition and sales area is completely free. Some special artist seminars and other paid events are being planned too.)

☐ Anticipated attendance : 1,800+

☐ Previous attendance results :

2019: 1,000+

2022: 1,600+

☐ Hosted by: Tokyo Pedal Summit Committee

Official web : [tokyopedalsummit.jp](http://tokyopedalsummit.jp)  
Contact : [tokyopedalsummit@gmail.com](mailto:tokyopedalsummit@gmail.com)



@pedalsummit



@tokyopedalsummit

Hashtag : #東京ペダルサミット #tokyopedalsummit

# About Exhibiting

☆ Effector Zone

● ¥66,000 per booth (limited up to two booths per company/brand)

※ No discount for multiple booths.

Booth Size: 1,800mm × 1,600mm

Each booth comes with (1) 1800mm (W) x 600mm (D) x 700mm (H) table, two chairs, and one power outlet.

Application Form for Exhibitor

<https://forms.gle/oEV74RCoEXBWYWSr5>

\*Please let us know what you will exhibit at the time of application.

\*You can exhibit guitar pedals and related products such as cables, pedal boards, parts etc.

\*Exhibits must primarily be displayed on the table provided. If you have pedal boards you can also display them at foot level in front of the table.

\*Don't bring large fixtures or create structures using the walls or ceiling. Wall surfaces can't be used.

\*We recommend you to use headphone amps. A soundproof booth will also be provided at the main hall, so you can also conduct product demonstrations there using a real amp on a limited basis. Rules pertaining to the use of real amps will be provided later.

\*We only accept the payment via PayPal. We will send you the invoice with our PayPal account information once the application is complete.

We will not accept the cancellation after payment.

# Venue

## CITY HALL AND GALLERY GOTANDA

8-4-13, Nishi-Gotanda, Shinagawa, Tokyo, Japan

<https://gotanda-hall.jp/index.html>

Gotanda Station is on the Yamanote Line, and 30 minutes by train from the Shinjuku area. It's also easily accessible from Haneda or Narita Airport. The location is also close to many restaurants and Japanese Izakaya so it's a good location to get some of that "Tokyo" atmosphere.

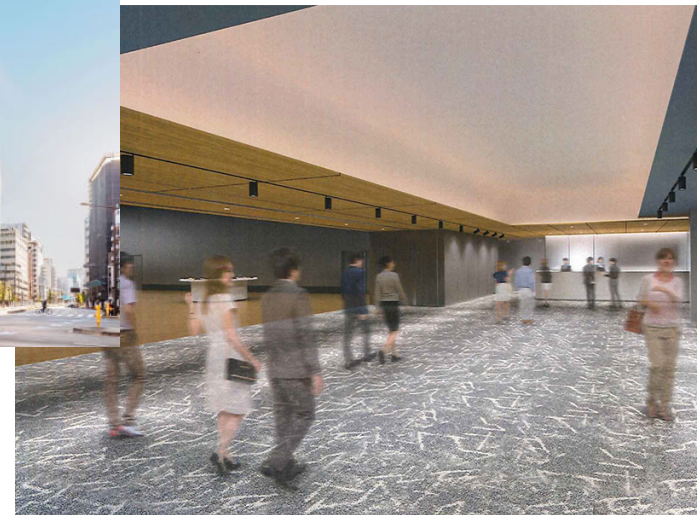

# Booth Plan

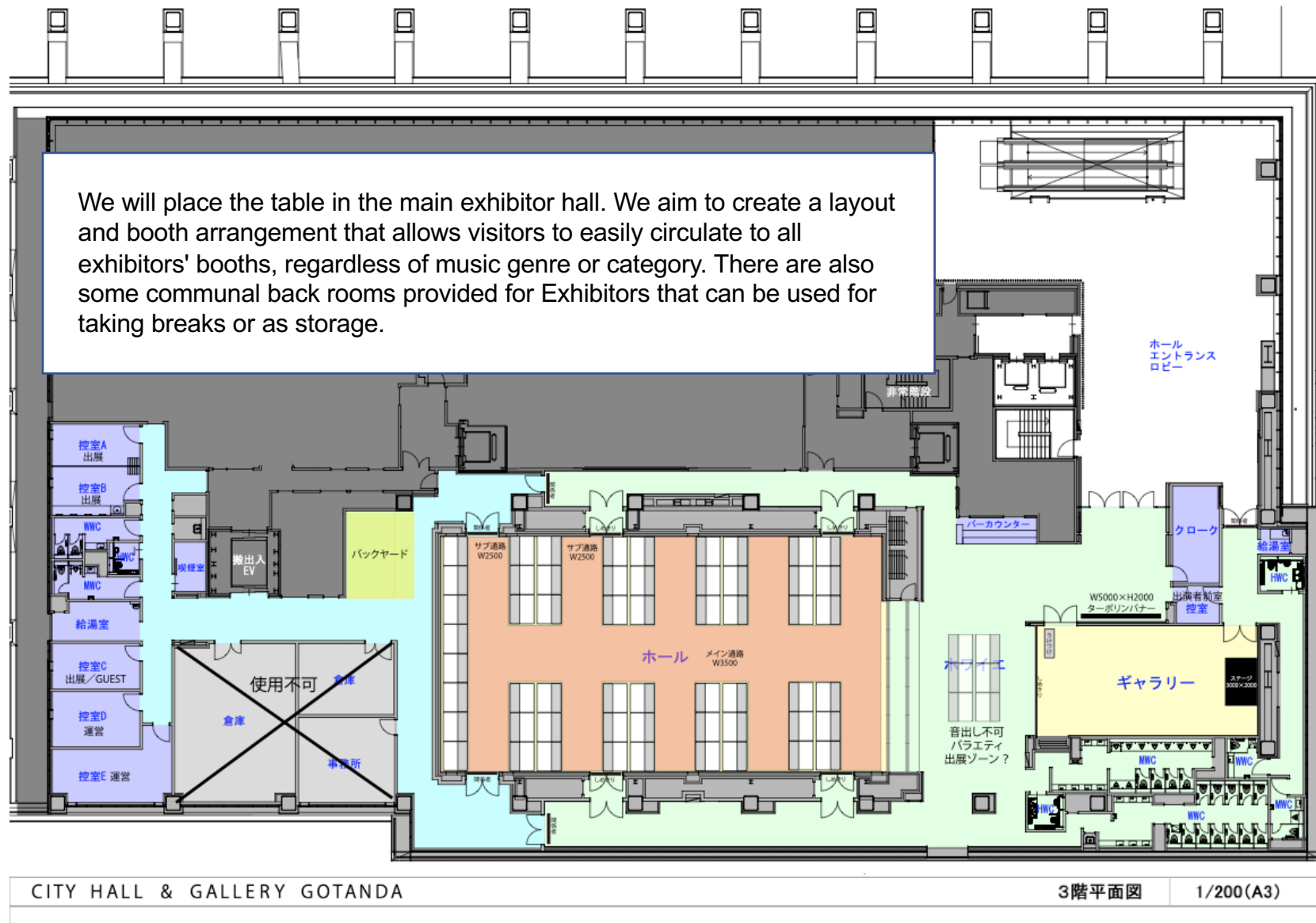

With one booth order, we will prepare 1800mm x 1600mm space, 800mm(W)×600mm(D)×700mm(H) table, two chairs and one power outlet.

# Exhibitors FAQ

Q : Can I use real amps?

A : You can use both real or headphone amps. For real amps, time and volume restrictions may apply according to the rules that will be provided by the event management. Rules must be strictly observed. Headphone amps can be used at any time.

Q: How can I use the power outlet?

A: One power outlet will be provided per booth. Please provide your own extension cords and power strips as necessary.

Q : Can I sell products?

A : All exhibitors are welcome to sell their products. There is no on-site sales fee. The Management Committee cannot provide money storage, provide change, or credit card processing, so each exhibitor participating in sales is responsible for preparing their own safe, change, credit card terminals, and other necessary items.

Q: Is Internet access available?

A : Wifi will be available at the venue, but the signal may be weak or unstable depending on the usage.. If you intend to use web-based promotional activities or payment terminals, please prepare your own WiFi.

Q : What is the schedule for loading and unloading?

A: You can set up from 1:00 PM on October 25 (Fri.), the day before the event. Complete take down and load out must be completed by 10:00 PM on October 27 (Sun.).

Q : What should we do about loading in and unloading by car?

A: There is an entrance at the back of the venue. You will need to apply in advance, especially if you are bringing your car for load-in and load-out. The Tokyo Pedal Summit Committee will provide separate information on all loading and unloading methods soon.

Q: Is car parking available?

A : There is no free parking for exhibitors or visitors at the venue. Please use the public parking.

Q : Can I take pictures at the venue?

A : Anybody can take photos, but if visitors, exhibitors, or guests (including performers) wish to shoot videos for a monetized project they need to apply beforehand. We will inform you of the details in advance. Magazine and web media also must apply in advance.

Q : Can I eat and drink in the venue?

A: Eating and drinking are prohibited in the main hall and gallery but are allowed in the "Foyer" area. Exhibitors may also eat and drink in areas that are off-limits to the general public, such as the backyard break rooms.

Q : Is there a smoking area for Exhibitors?

A : Exhibitors may use the smoking area in the backyard of the venue. The back of the venue includes artists' waiting rooms so general visitors are prohibited from entering.